

## TECHNICAL DATA SHEET

### SECUPRO MEGASAFE NO. 116006

#### Safety technology

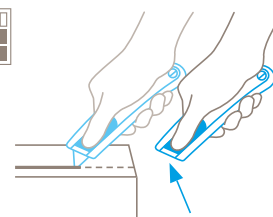

#### Fully automatic blade retraction – a very high degree of safety

The fully automatic blade retraction of the SECUPRO MEGASAFE guarantees a very high degree of safety from cut injuries. The blade withdraws into the handle immediately after leaving the material being cut. Even if the slider is still being activated.



#### SAFETY KNIFE MADE OF ALUMINIUM WITH FULLY AUTOMATIC BLADE RETRACTION.

**Order No.** 116006.02

#### Quality that's visible. With rounded-tip trapezoid blade.

Would you like to have a safety knife with a large blade extension? Or are you looking for a cutting tool that can cope with the toughest of tasks? In both cases, the SECUPRO MEGASAFE is an excellent choice. Thanks to a cutting depth of up to 17 mm, this knife doesn't shy away from a challenge. And no matter your task, safety is always guaranteed; the fully automatic blade retraction functions even when you decide to not fully extend the blade.

#### Robust handle

The body of our top quality SECUPRO MEGASAFE is 100% aluminium. And ultimately, 100% robust. You can master all manner of standard cutting materials with this safety knife. Even multi-layered ones.

#### Change without opening

Blade change is easy and safe. Simply push down on the back end of the rocker device located on the top side of the

safety knife, and push the slider completely forward. The blade is ready for changing.

#### Perfect handling

The lightly rounded handle fits particularly well in your hand. Your thumb doesn't get a raw deal either: soft grip on the slider makes for a pleasant, slip-resistant resting pad.

#### Double-sided slider

With the right hand? With the left hand? No need to ask this question! The SECUPRO MEGASAFE is fitted with a slider that's accessible from both sides. Choose for yourself!

#### 2-cutting edge blade





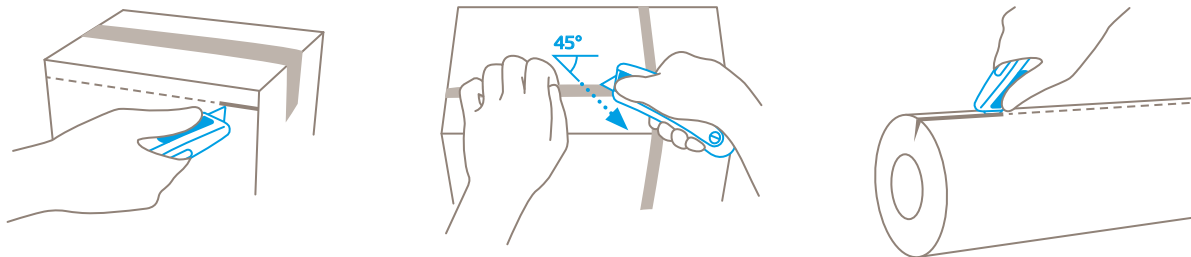





Before you need to change the quality blade, you have the chance to turn it over once. Usage time of the blade is doubled and fatigue is held at bay: with a simple flip of the blade, your SECUPRO MEGASAFE will cut like new.

## USAGE



## PRODUCT FEATURES

### Technical features

 Very high safety	 Tool-less blade change	 Very abrasion resistant	 Ergonomic
 2-cutting edge blade	 Cutting depth	 Rounded-tip trapezoid blade	 Ceramic blade insertable
 Soft grip	 For right and left hands	 Printable for promotional purposes	

### Main cutting materials

 Cardboard: up to 3-ply	 Plastic strapping band	 Bagged goods	 Slabbing material off a roll
 Wrapping, stretch and shrink foil	 Tape	 Layers of foil or paper	 Rubber
 PVC	 Yarn, cord	 Felt	 Fleece
 Textile, material			

### Installed blade



**NO. 60099**  
0.63 mm, rounded blade tips, deep-edged

### Optional blade



**NO. 60099C**  
0.65 mm, ceramic, rounded blade tips, deep-edged



**NO. 99**  
0.63 mm, deep-edged



**NO. 199**  
0.63 mm, deep-edged, stainless



**NO. 98**  
0.63 mm

## BLADE CHANGE

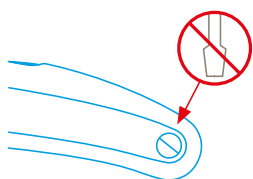

**Do not unscrew** the handle to change the blade!

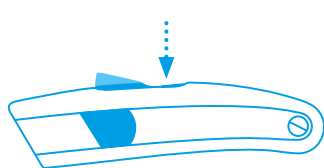

Press the **rocking element downwards**.

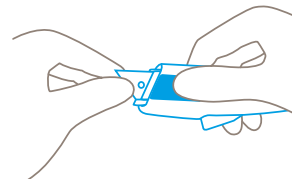

Move the slider fully forwards. Turn the handle so that the **transparent blade cover faces upwards**.

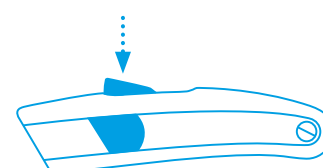

Now **rotate or change the blade** and carefully release hold of the slider. Close the rocking device.

## SERVICES OFFERED



Safety poster



Training video



Technical data sheet



Consulting service

## PRODUCT AND PACKAGING DETAILS

Order No.	NO. 116006.02	Packaging unit	1 in single unit box
Knife size (L x W x H)	153 x 26 x 38 mm	Size Single unit box	160 x 28 x 45 mm
Weight knife	142.0 g	Weight single unit box	160.0 g
Basic material	Aluminium	EAN Code single unit box	4002632919893
Cutting depth	17 mm	Quantity in outer pack	10 knives
		Size outer pack	144 x 100 x 168 mm
		Weight outer pack	1660.0 g
		EAN Code outer pack	4002632971211
		Customs tariff number	82119300

## SAFETY CERTIFICATE

Date of issue	01.07.2016
Certification	GS certificate NO. S 60112078

### Certificates and awards



## SAFETY INSTRUCTIONS

To ensure that you use your new MARTOR knife safely and most effectively, please read and note the following user-instructions. Please keep the written guide in a safe place so that you can access it at any time.

**1. General application instructions:** Please always use the product carefully for manual cutting work only and not for any purposes other than those that are intended. Please take the correct handling and the proper use of the knives into account in this regard. As an additional safety measure, we recommend the wearing of safe gloves.

**2. Special application instructions to avoid the danger of injuries:** Only use knives that are in perfect condition and have sharp, clean and undamaged MARTOR blades. Employ the utmost care when handling the knives. Prior to use, familiarise yourself with the safety features and their functioning. Ensure that these safety features are not impaired by the type of material to be cut. **CAUTION:** The blade is sharp and can result in serious and deep cuts. Therefore, never reach into the blade! Do not place your free hand in the line of cutting and never cut directly towards you.

**3. Replacement of spare parts:** Replace any blades that become dull at the right time! Use only the replacement blades from MARTOR for this purpose. Dispose of old blades in a

proper fashion. They should not be placed in a waste paper bin, as this poses a considerable danger of injuries. Never perform any repairs yourself. If the knife shows signs of aging or any other wear, e.g. which impair safety features, blade changing or usage, the knife must be taken out of service and replaced. Do not modify this product in any way. Modifications of any kind may impair product safety. **CAUTION:** The risk of injury caused by manipulation of this product is extremely high.

**4. Non-use of the knife:** Always secure the blade in such a way (depending on product type) that injuries due to cuts are excluded. Store the knife in a secure place.

**5. Care instructions:** To guarantee a long service life, always keep the knife clean and do not expose it to unnecessary soiling and humidity.

**CAUTION: No liability will be assumed for consequential losses. Subject to technical changes and errors! This knife does not belong in the hands of children!**

## ACCESSORIES

---

### BELT HOLSTER M WITH CLIP NO. 9921



What do you do with your cutting tools when you are not actually using them? The MARTOR BELT HOLSTER M is a robust holder that allows you to carry all midsize MARTOR knives as well as our safety scissors at all times. In addition, the interior and exterior pockets are designed to allow you to load different tools: for example you can carry an extra safety knife, a pen and a pack of blades. The MARTOR BELT HOLSTER is the ideal place to stow your tools safely when moving from A to B - and have them at hand, as soon as they are required.

### USED BLADE CONTAINER NO. 9810



You can fill the USED BLADE CONTAINER with the content of your SAFEBOX. Or directly with your used blades. When the box is full, turn the lid until it shuts. Now the box cannot be reopened. The next step is to safely and completely dispose of the filled USED BLADE CONTAINER as normal waste.

### WALL MOUNT BRACKET USED BLADE CONTAINER NO. 9845

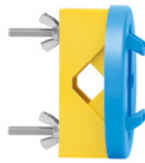

Include it in your order now! With this mounting bracket you can fix your USED BLADE CONTAINER to a central location. Use the clamp and screws and nuts supplied with the product to attach it to either a pipe or a rod.

### SAFEBOX NO. 108000



The SAFEBOX is large enough to store a large number of used blades safely. And at the same time, it is compact enough to carry with you. The two slits are not only used for filling, but also to „shorten“ your snap-off blades. When your SAFEBOX is full, empty it into your USED BLADE CONTAINER.

---

## MANUFACTURER

MARTOR KG | Lindgesfeld 28 | 42653 Solingen | Germany  
T +49 212 73870-0 | info@martor.de | www.martor.com