

SECUNORM MULTISAFE

Automatic blade retraction
for a high degree of safety

Slider on top of the handle
for right and left handers

Ergonomic handle
for efficient working

2-cutting edge blade
with a large cutting depth

Unpainted zinc
for top performance



USAGE

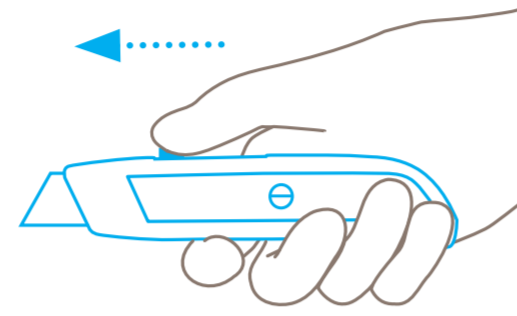

Extend the blade by moving the slider forward.

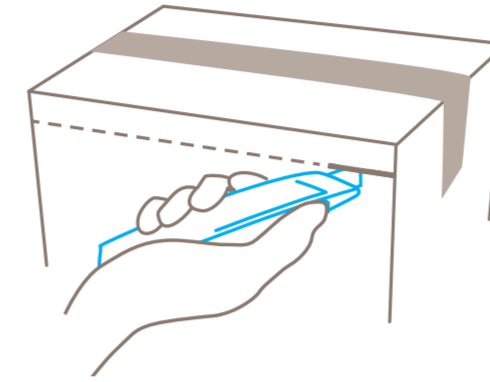

Pierce into the cutting material to cut.

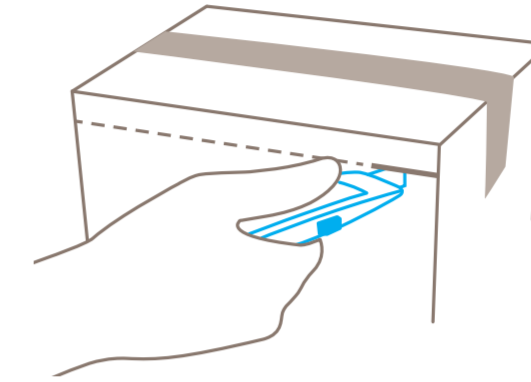

Always remove your **thumb from the slider** to ensure automatic blade retraction.

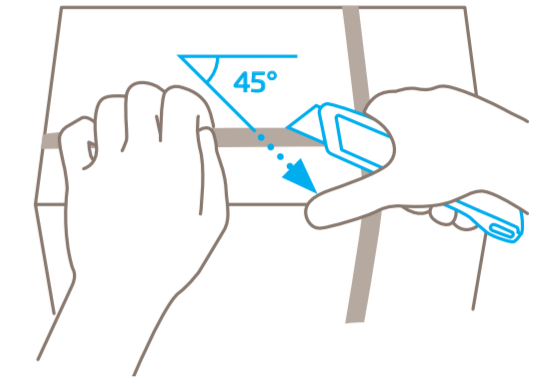

For best results, cut plastic strapping band **diagonally** (at a 45° angle).

BLADE CHANGE

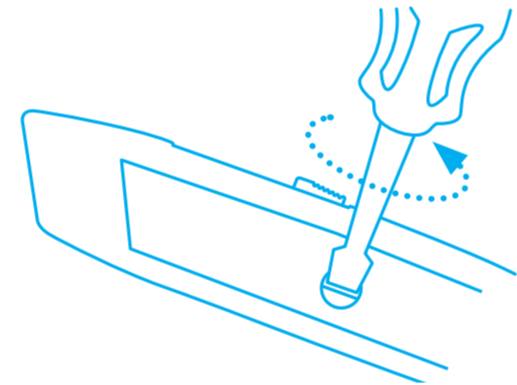

Unscrew the handle and remove the upper half of the handle.

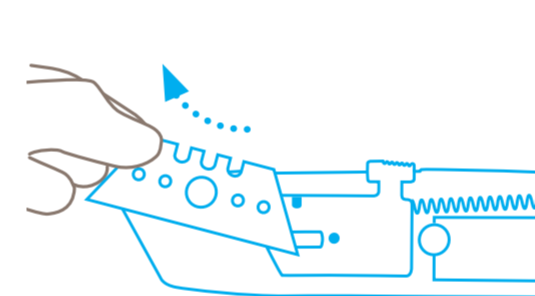

Reverse or replace the blade.

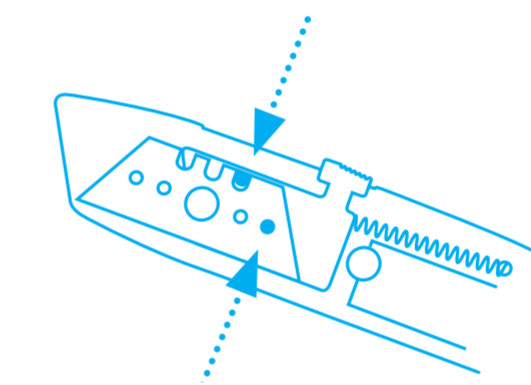

Make sure you place the blade **exactly** on the locating lobe.

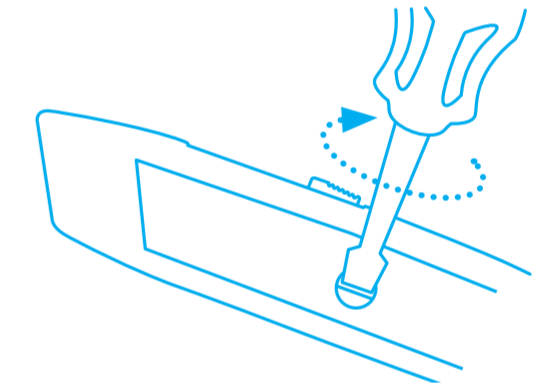

Place the upper half of the handle back on the lower half and fasten the screws **tightly by hand**.

PROTECTION OF USER

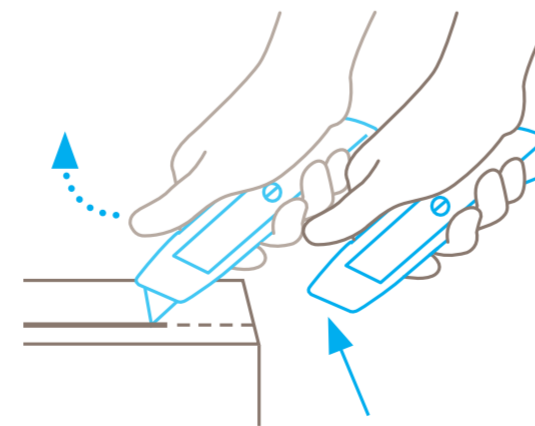

Following cutting, the blade immediately retracts into the handle. Condition: you have **released hold of the slider**.

DISPOSAL

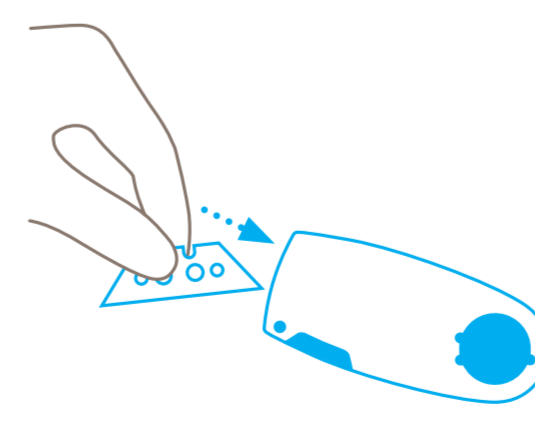

Your **SAFEBOX** is the best place to store **used blades**.

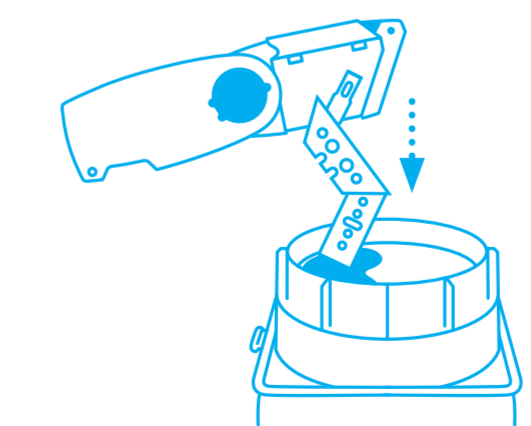

When the **SAFEBOX** is full, **empty all contents** into your **USED BLADE CONTAINER**.

Please note: To ensure your product always functions flawlessly, regularly remove any impurities. For additional safety, we recommend wearing gloves.