

SECUNORM 185

EFFICIENT TO CUT. COMFORTABLE TO USE.

NEW

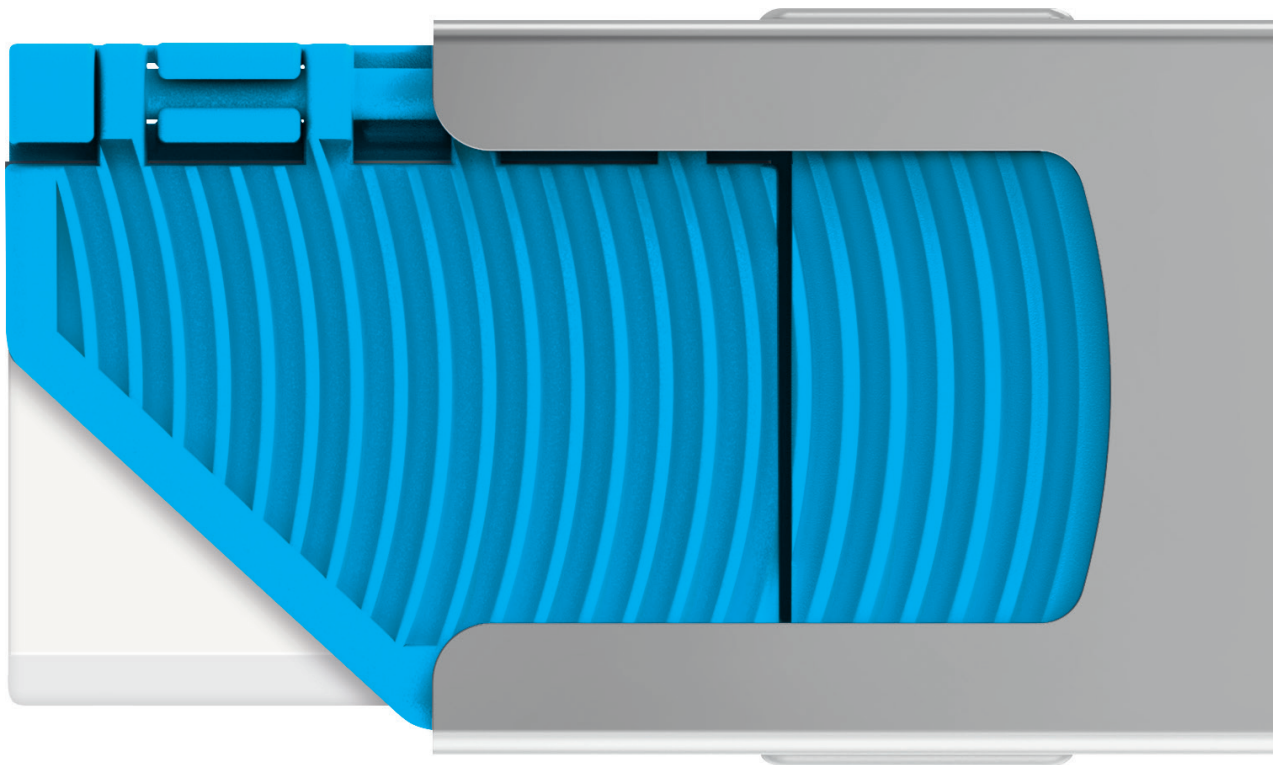

THE SAFER WAY TO CUT.

**martor**

# SECUNORM 185

NO. 185004



Original size

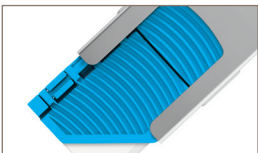

#### Robust and practical

The SECUNORM 185's handle is made of stainless steel, designed for frequent cutting and long service. The knife has an ergonomic practical format and light-weight design to make cutting easier.

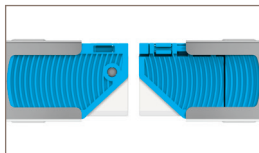

#### Optimal slider

The double-sided slider is suitable for both right and left handers. It has a large surface for perfect operation even when wearing gloves. Grooves on the slider improve slip resistance.



#### Safe blade change

Simply hold down the blade change button and pull the slider out from the front to access the blade. The plastic insert and handle remain together so that nothing will be lost.



#### Practical eyelet

The SECUNORM 185 is equipped with an eyelet for attaching a strap, securing the knife to be on hand as soon as the next package needs opening.



#### 4-cutting edge blade

The blade has four cutting edges that can be used one after the other. This makes economic and ecological sense and, with a fresh cutting edge, you can always cut like new.

**Lots of knife requiring little space. With ceramic blade.**





Efficiency is important when opening cartons and pallets. Just what the nimble and robust SECUNORM 185 has been designed for. The compact safety knife impresses with features rarely found in this product group, such as a stainless steel handle, a large slider and easy blade change. changing. Other benefits are the sharp, long-lasting ceramic blade and automatic blade retraction.

**PRODUCT FEATURES**

**Technical features**

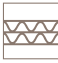
-  High safety
-  Tool-less blade change
-  Abrasion resistant
-  Ergonomic
-  4-cutting edge blade
-  Cutting depth
-  Ceramic
-  For right and left handers
-  Lanyard hole

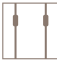
**Main cutting materials**

-  Cardboard: up to 2-ply
-  Wrapping, stretch and shrink foil
-  Tape
-  Plastic strapping band
-  Layers of foil or paper
-  Yarn, cord

**Installed blade**

- 
- NO. 92C**
- 0.50 mm, ceramic, deep-edged

**Optional blade**

- 
- NO. 92**
- 0.40 mm
- NO. 192**
- 0.40 mm, stainless
- NO. 60092**
- 0.40 mm, rounded blade tips
- NO. 92043**
- 0.40 mm, deep-edged
- NO. 192043**
- 0.40 mm, deep-edged, stainless

**Certificates and awards**



**Application**

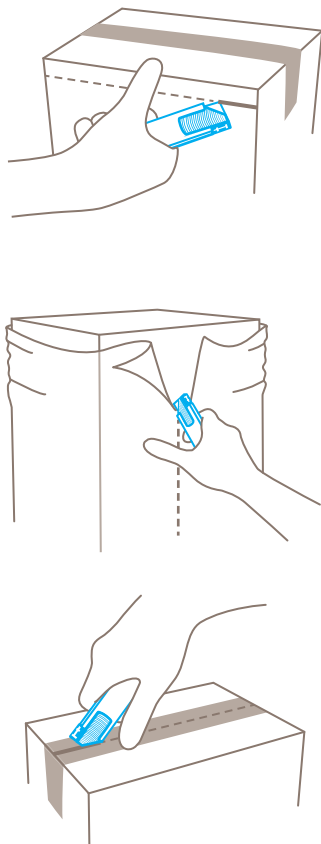

**Safety technology**

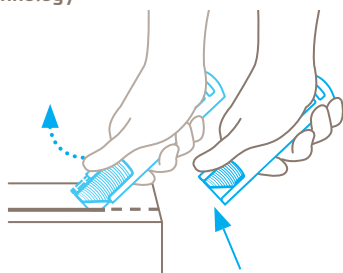

**Automatic blade retraction – a high degree of safety**





The automatic blade retraction of the SECUNORM 185 guarantees a high degree of safety from cut injuries. As soon as you have started to cut, take your thumb off the slider. Then the blade will retract into the handle immediately after leaving the material being cut.

# YOU CAN FEEL THE QUALITY.

## SECUNORM 185

- › Robust, stainless steel handle made of metal
- › Small and handy
- › With ceramic blade
- › Automatic blade retraction
- › GS-certified for approved safety

## PRODUCT DETAILS

<b>Order No.</b>	NO. 185004.17
<b>Packaging unit</b>	1 in single unit box (20 in multipack)
<b>Knife size (L x W x H)</b>	102 x 26 x 7.2 mm
<b>Main material</b>	Stainless steel
<b>Weight</b>	31.8 g
<b>Cutting depth</b>	9 mm
<b>Spare blade Packaging unit Size (L x W x Thickness)</b>	NO. 1792.25 (2 on self-service card) 26 x 18.5 x 0.50 mm
<b>Certified</b>	GS certificate NO. 180823-7255-55094- 2021
<b>Accessories</b>	
BELT HOLSTER S WITH CLIP	 NO. 9920
SAFEBOX	 NO. 108000
USED BLADE CONTAINER	 NO. 9810
WALL MOUNT BRACKET USED BLADE CONTAINER	 NO. 9845

## CONTACT AND SERVICE

What makes our cutting solutions even safer? Our advisory services! We are always on hand, to give advice, to provide you with training material, to meet with you in person if necessary.

You will find further information on our website: [www.martor.com](http://www.martor.com)



At a glance: the safety poster shows the most important functions and correct usage – perfect for your workplace.



Everything you want to know: dimensions, properties, special features and more about our cutting tools can be found in the technical data sheet.



Still have questions? You can reach our service department on [+49 212 73870-0](tel:+49212738700)